

## BRANDON HERITAGE CENTRE & FLINT MUSEUM - Rosemary Foreman

**Opening Times:** During normal times the Centre is open Saturdays and Sundays, 10am-4pm, April to October. Please check the website.

**Admission:** Please check their website.

**Website:** <https://www.brandonheritage.org.uk>

**Email:** [admin@brandonheritage.org.uk](mailto:admin@brandonheritage.org.uk)



**Travel Time:** From Newmarket by car - approximately 30 minutes.

**Parking:** Free parking is one minute walk away in George Street.

**General Information:** The Heritage centre, founded in 1991, is located within the Old Fire Station in Brandon.

It has a permanent display recording Brandon's history from Stone Age through to the present day.

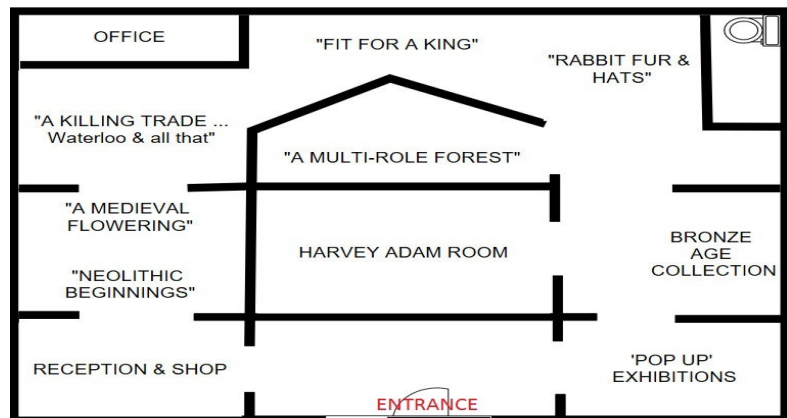

Brandon's main trade was flint and the chalk strata where flint is found is around 90 million years old. When struck flint readily produces sparks so it was used for over a century with guns, especially for the Battle of Waterloo. However flint also proved an excellent building material. Raw flints were mainly found near the surface at two sites: Lingheath and Brandon Park.

Fresh flint is black with a whitish skin, but when broken or weathered many colours can be seen. The extracted flints were taken to workshops in Brandon and broken into manageable chunks (quartering), which were flaked and knapped into gun flints before percussion caps were introduced. The industry had died out by the mid-20th century but was last to be seen in sheds behind the Flintknappers Arms pub.

A century ago Lingheath was a lunar landscape of chalk mounds in horseshoe shapes around the flint pits or burrows, which were dug out facing south to capture more daylight. Although the land has now been reclaimed for farming some remnants can still be seen in the forest at Session Heath. The debris from the industry was piled up at the eastern end of the town and was used as ballast for the railways or building works.

**Photos:** Courtesy of Brandon Heritage Centre & Flint Museum