

## SUMMER SCHOOL 2021

*Getting back into the swing!*

A special day of talks, live music and guided walks

**Tuesday 17<sup>th</sup> AUGUST**

St. Bride Foundation Institute, 14 Bride Lane (off Fleet Street) EC4Y 8EQ  
(Easy access from Blackfriars underground station or City Thameslink)

**Tickets: £33 including refreshments and a cold buffet lunch**  
**This event is for u3a members only**

The following pages contain a map with directions, a timetable, floorplan, and details of each session and speakers.

**Online booking:** If possible, please apply and pay on-line – it's quick and easy, saves paper and money, and helps with administration. Please click on the link to Summer School Online Application on the Events page of the London Region website <https://u3asites.org.uk/london-region/events>

**Postal booking:** If not possible for you to apply on-line, you may request a paper copy of the programme and postal application from the contact below. Please enclose a stamped self-addressed envelope.

**Booking confirmation:** Your booking confirmation form will be sent to you by email on receipt of payment, whether you apply online or by post. If unable to provide an email address, please send a stamped self-addressed envelope with payment and copy of application. Please bring your booking confirmation with you on the day as it will act as your ticket.

**Refunds** may be given in exceptional circumstances until 17<sup>th</sup> July. Should it be necessary to cancel the event after 17<sup>th</sup> July, we will notify everyone and offer the option of a revised date or full refund.

Contact for further information: Catherine Ware [Talks.lru3a@gmail.com](mailto:Talks.lru3a@gmail.com) or Tel: 020 8879 0352

# LONDON REGION OF U3As SUMMER SCHOOL TUESDAY 17<sup>TH</sup> AUGUST 2021

## KEEPING YOUR WELLBEING IN MIND

With the lifting of government restrictions expected on 19<sup>th</sup> July, we are looking forward to seeing everyone in person again!

We have everyone's wellbeing and enjoyment in mind. Key points are noted in this Programme to help you decide about participation, but feel free to ask questions if you have any particular concerns.

- **Pre-attendance:** Please review your own personal health and circumstances. Refer to current government guidance and the [NHS Website](#), for different Covid-19 risk categories -- especially if you or members of your household are at higher risk of serious illness from coronavirus, or other potential health risks. Do not attend if you or others in your household have Covid symptoms.
- **Public transport:** The venue is centrally located in London and well served by public transport (see map p.3). The event starts at 11.00 (doors open from 10.30) and ends by 16.30, so most participants should be able to travel outside peak hours. It is the responsibility of each member to consult advice issued by public transport services and assess any risks associated with their travel plans.
- **On arrival:** We will not be asking for proof of Covid testing or vaccination, but it is expected that attendees will be required to register for Track and Trace by scanning St. Bride's QR code using the NHS Covid-19 app on their mobile 'phones; or completing the printed forms requesting contact details. In addition, our event Volunteers will check you in and give you your name label – please bring your booking confirmation as it is your ticket. Please attend the morning briefing at 11am.
- **The St. Bride Centre** is well prepared for hosting large events such as weddings, conferences etc. and are closely following government guidelines. Despite the anticipated lifting of all restrictions, some precautions are still likely to be advisable in August (e.g. hand sanitation/general hygiene, good ventilation, sensible social distancing. Mask optional). If you feel unwell during the event, please inform one of the Event Team immediately. The Application form asks for a second (optional) contact number to be used only In Case of Emergency on the day.

We have hired two halls to provide plenty of space: Bridewell Hall for talks and the piano performance; Farringdon Hall for Lunch and Refreshments. See floorplan p.4.

- **Guided Walks:** Our experienced Walk Leaders have completed risk assessments for their own walks and any significant points are noted in the Programme description or will be communicated in the pre-walk briefing. However the following general points apply to all walks:
  - All walks are scheduled for 2hrs, beginning and ending at St. Bride's. Participants should not leave the group without agreement of the Walk Leader.
  - Wear suitable footwear and clothing; bring drinking water and other essential personal items, including a mask/hand sanitiser in case needed.
  - Volunteers will register Walkers and introduce them to their Walk Leader who will brief their group in more detail about the route (including loop stops) and any specific instructions. A back-marker will be assigned to help. All Walk Leaders will be equipped with voice amplification equipment.

# LONDON REGION OF U3As SUMMER SCHOOL TUESDAY 17<sup>TH</sup> AUGUST 2021

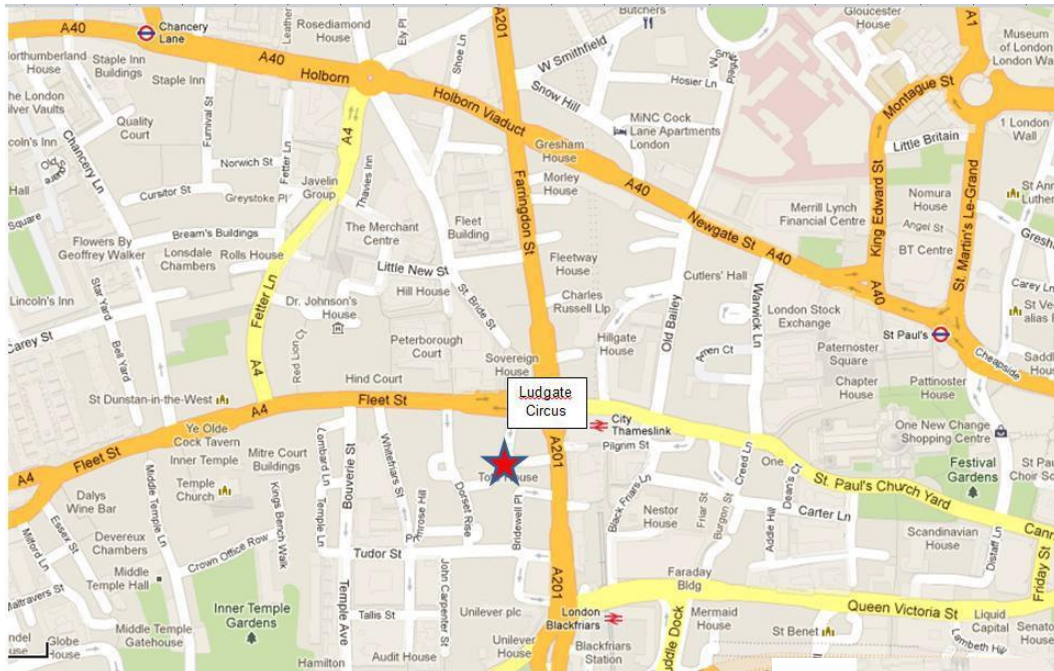

## DIRECTIONS

**St Bride Foundation Institute,  
14 Bride Lane (off Fleet St) EC4Y 8EQ**

**By rail** – City Thameslink (2 mins)  
London Blackfriars (5 mins)

**By Tube** – Blackfriars (5 mins)  
St Paul's (7 mins)  
Chancery Lane (10 mins)

*All these stations are shown on this map*

**By bus** – 4, 11, 15, 23, 26, 76, 172 along Fleet St  
45, 63, 100 along New Bridge St

For step-free access go from Fleet Street via Salisbury Court & St. Bride's Passage

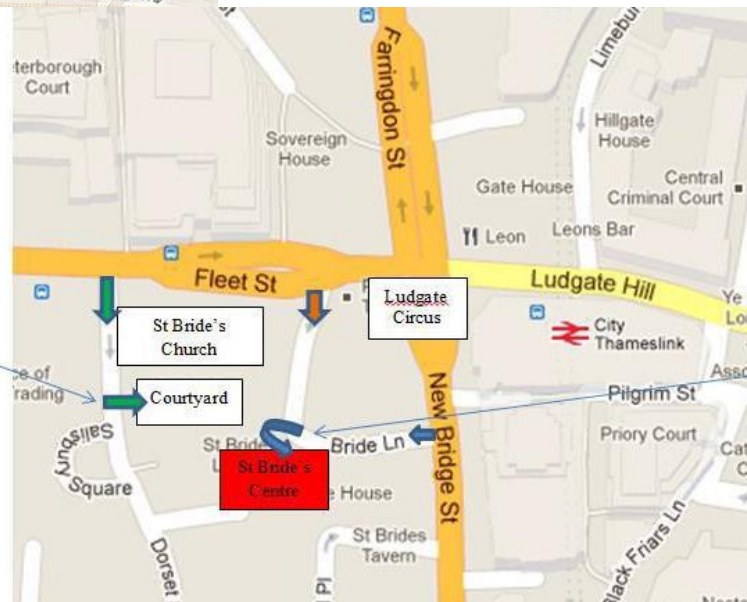

Steps from Bride Lane

## ST. BRIDE CENTRE FLOOR PLAN

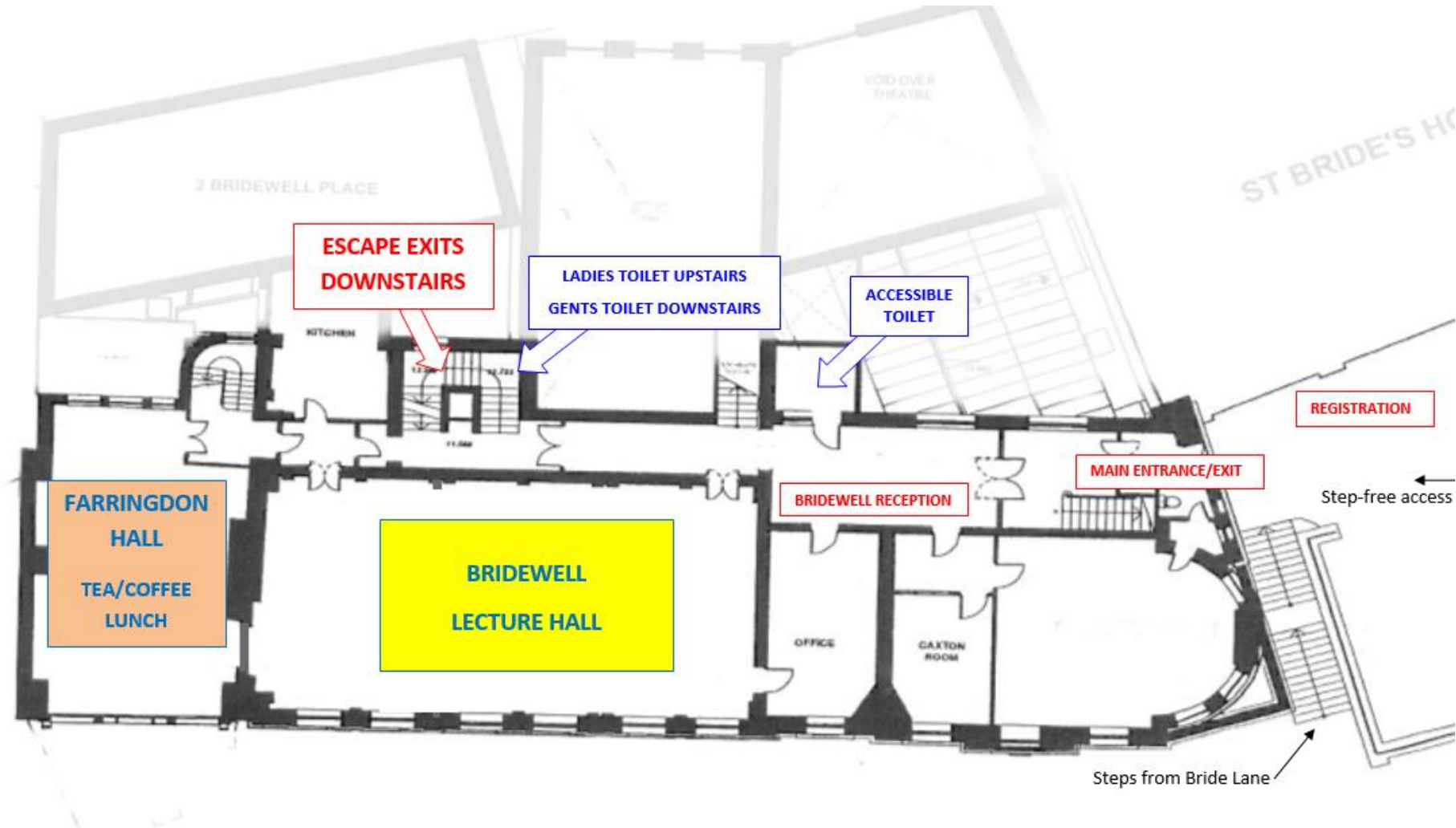

LONDON REGION OF U3As SUMMER SCHOOL TUESDAY 17<sup>TH</sup> AUGUST 2021

**TIMETABLE**

10.30-10.50	Registration & Coffee			
10.50-11.00	Plenary – Notices for the day			
	<i>Note: All walks start and finish at St. Bride's unless otherwise agreed in advance with Walk Leader</i>			
	<b>TALKS</b>	<b>WALK</b>	<b>WALK</b>	<b>WALK</b>
11.00-12.00	Matt Brown London's Forgotten Disasters (H)	Helen Long Crossing the Thames (H)	Christine Wilkins-Molloy Murder, Mystery, Mayhem & Medicine in The City (H)	Oonagh Gay The Roaring Twenties: Literary & Political Bloomsbury (L/P '20s)
12.15-13.15	David Evans Voices in the Dark: Talking Pictures (D/'20s)			
13.15-14.15	LUNCH			
	<b>TALK</b>	<b>WALK/WORKSHOP</b>	<b>WALK</b>	<b>WALK</b>
14.15-15.15	Graeme Roy Glory Years of Air Travel: Croydon Airport 1920s-'30s (T/'20s)	John Naylor London Sound Walk 1hr Walk followed by 1hr Workshop (S/A)	Hazel Beale Tate Modern Inside and Out from 1920s to 2020s (A/'20s)	Keith Kirby Victoria Embankment Gardens Walk (H)
15.30-16.30	<b>LIVE MUSIC</b> Mike Head Blues, Ragtime, Boogie... (M/'20s)			

**Key to topics:**

A=Art; D=Drama; H= History; L= Literature; M=Music; P=Politics; S=Sciences; T =Travel; '20s = 'The Twenties'

## LONDON REGION OF U3As SUMMER SCHOOL TUESDAY 17<sup>TH</sup> AUGUST 2021

SPEAKER	SESSION Topic	DESCRIPTION AND SPEAKER DETAILS
<b>Matt Brown</b>	<b>TALK History</b>	<p><b>London's forgotten disasters:</b> The Black Death, the Great Fire and the Blitz famously ravaged London, but other lesser-known disasters have struck the capital with brutal randomness over the centuries. This talk will inform and surprise with strange and obscure stories of how the capital has accidentally seen off large numbers of its inhabitants.</p> <p>Matt has spent 16 years writing, filming and exploring London as a contributor and editor for Londonist.com, a website about London's history and culture. He is the author of 11 books including Everything You Know About London is Wrong, and London Night and Day. He lives in extreme-north-London (or Hertfordshire as most people call it) with his wife, two children and a very heavily used Oyster card.</p>
<b>David Evans</b>	<b>TALK Drama/ '20s</b>	<p><b>Voices in the Dark - the Birth of Talking Pictures:</b> This talk looks at how the coming of sound changed film, forever, and how the movie industry met some of the challenges this involved.</p> <p>David is a regular speaker on the London and Home Counties U3A circuit, and he is also a registered City of London and City of Westminster Guide. Before retirement he spent his entire career with Air France, latterly training ground staff in many aspects of their work. (Member of Hammersmith &amp; Fulham u3a)</p>
<b>Mike Head</b>	<b>LIVE MUSIC/ '20s</b>	<p><b>Blues, Ragtime, Boogie....and Beyond:</b> In this informal concert for the piano, Mike plays a programme of mainly his original compositions, and he will introduce each piece. Several pieces reflect the piano music of the early 20th century -- a time when popular music was still young. Other pieces portray a wide range of influences, from 17th Century England to 20th Century Spain.</p> <p>Mike started to play piano and sang in his local church choir from the age of seven, and took up the guitar at age fifteen. In the 1960s, working as a civil servant in London, he was exposed to the capital's music at a time of incredible change &amp; experimentation, and this mindset has stayed with him. During this period, he led several groups on London's Jazz scene. In the early 1970s, he travelled to Morocco, Algeria &amp; Tunisia, making recordings of ethnic music which were broadcast in the BBC's Third Programme (now Radio 3).</p>
<b>Graeme Roy</b>	<b>TALK Travel/ '20s</b>	<p><b>The Glory Years of Air Travel – Croydon Airport 1920-1930s:</b> The '20s and '30s are considered to be the glory, and pioneering, years of air travel. During this period, Croydon Airport was London's main international airport as well as the start or finishing point for many record-breaking flights. This presentation will chart the history of Croydon Airport, the experience of flying long distances in those early aircraft, and highlight many of the celebrities who passed through the airport's doors. It will also feature Amy Johnson, perhaps the most celebrated aviatrix of that time.</p> <p>Graeme is a Trustee of the Historic Croydon Airport Trust, the charity which preserves the legacy of Croydon Airport through operating the Museum and Visitor Centre in the original Terminal building; and preserving the extensive Archive relating to Croydon Airport's history. Graeme is himself a former pilot.</p>

## LONDON REGION OF U3As SUMMER SCHOOL TUESDAY 17<sup>TH</sup> AUGUST 2021

WALK LEADER	SESSION Topic	WALK DESCRIPTION AND WALK LEADER BACKGROUND
Hazel Beale	<b>WALK Art/ '20s</b>	<p><b>Tate Modern Inside and Out – from 1920s to 2020s:</b> The walk will start from St. Bride's and approach Tate Modern via the Millennium footbridge (the 'Wobbly Bridge') where some background to the Tate galleries and Bankside power station will be given. The building was designed by architect Giles Gilbert Scott. After viewing the external architectural features, we explore internal features and look at some artworks spanning the 1920s to the 2020s. After the walk there will be opportunities for coffee in the gallery café, viewing more artworks, and a visit to the 10<sup>th</sup> floor for beautiful views over London and the Thames. <i>(Max 20 participants)</i></p> <p>Hazel has lived in London for the past 22 years after moving from her home town of Bath. Her hobby is guiding in London where she is a volunteer guide with the British Museum and National Trust as well as leading walks as a City of London guide and with her local U3A (Member of London Southeast u3a).</p>
Oonagh Gay	<b>WALK Literature/ Politics/ '20s</b>	<p><b>The Roaring '20s -- Literary and Political Bloomsbury:</b> This walk will explore the lives of some of the notable authors living in Bloomsbury, from Virginia Woolf to Dorothy L Sayers, and new political movements associated with the feminist Lady Rhondda, whose journal Time and Tide pursued reform in literary and political life. <i>At 11am we will take a short bus ride (bus 17 from St. Bride's) to Guilford Street near Russell Square where the guided walk will start. After the walk we will return by bus to St. Bride's for lunch. (Max 15 participants)</i></p> <p>Oonagh is a lifelong Londoner, whose father was a local history expert, and she has qualified to guide in Islington and Camden, with a special interest in political and women's history. She is Chair of the Islington Guided Walks Association. Before retiring, she was a senior clerk in the House of Commons Library for 30 years, specialising in Parliamentary and constitutional research. She has been a walks convenor for Crouch End u3a.</p>
Keith Kirby	<b>WALK History</b>	<p><b>Victoria Embankment Gardens Walk:</b> The Embankment is the most enduring monument of Victorian enterprise, which literally changed the shape of London. Constructed by Joseph Bazalgette for the Metropolitan Board of Works 1865-70 the scheme reclaimed 37 acres (15 hectares) from the River, which are largely given over to public gardens. The gardens house many fine monuments to leading figures from British history. These include religious figures, social and educational reformers, cultural leaders and military men but only one woman (and a muse). <i>(Max 15 participants)</i></p> <p>Keith Kirby studied History and Social Policy. He worked as a Government researcher on housing policy for over three decades. He joined North London U3A on retiring in 2010 and has been a member of the Shape of London group ever since then. The group is concerned with all aspects of London, from the Romans to the present day.</p>

## LONDON REGION OF U3As SUMMER SCHOOL TUESDAY 17<sup>TH</sup> AUGUST 2021

<p><b>Helen Long</b></p>	<p><b>WALK History</b></p>	<p><b>Crossing the Thames:</b> We will walk beside the Thames looking at the City Bridges. These are Blackfriars, Southwark, Millennium Bridge, London Bridge and Tower Bridge. On the way walkers will learn about the City Bridge Trust and its origins in Medieval Times as well as how people crossed the Thames in times gone by. Walkers will find out the problems caused by the bridges such as the frozen river as a result of the structure of the medieval London Bridge and how this bridge was used to deter traitors or those who disagreed with the monarch. Walkers will learn the history of all 5 bridges, will find out what happened to them and will see the different designs put forward for the present Southwark Bridge and a model of the medieval London Bridge. <i>Return to St. Bride's by bus 15 to Fleet Street or, if we are in a hurry, the Circle line to Blackfriars. (Max 25 participants).</i></p> <p>Helen has led walks for the London Region Summer School in 2017,2018 and 2019. She is a Green Badge Guide, a City Guide, Westminster Guide and Clerkenwell and Islington Guide as well as a guide at St. Paul's Cathedral and St. John's Gate. She is also Groups Organiser and in charge of visits for Wandsworth u3a.</p>
<p><b>John Naylor</b></p>	<p><b>WALK/ WORKSHOP Science/Art</b></p>	<p><b>London Sound Walk:</b> The purpose of this walk/workshop is to make one aware of the city soundscape by walking in silence and listening attentively to ambient sounds. Doing so, one becomes conscious not just of individual sounds and how they are affected by the circumstances in which they are heard, but also of their acoustic and aesthetic qualities and much else. The one-hour walk will be followed by a 1hr workshop with participants discussing what they have got out of the event. <i>Route map &amp; instructions to be sent to applicants in advance. (Max 15 participants)</i></p> <p>John spent most of his youth in Peru and Pakistan. After studying engineering and philosophy at the University of London, he taught physics in various secondary schools for the next thirty years. He retired from teaching in order pursue his life-long interests in atmospheric optics and acoustics, astronomy, and the history of science and ideas. He is the author of "Out of the Blue" (CUP, 2002), a guide to the vast range of optical and astronomical phenomena that can be seen in the sky, day and night. He has just written a book on sound and listening that will be published next year (title to be announced) and is a member of Merton u3a.</p>
<p><b>Christine Wilkins-Molloy</b></p>	<p><b>WALK History</b></p>	<p><b>Murder, Mystery, Mayhem and Medicine in The City:</b> The streets now crowded with bankers and IT professionals were once the scene of riots, religious controversies and public executions. We will explore the dark side of the city, including the mystery of 'Scratching Fanny', and Roaring Twenties murder trials in Criminal Court Number One. The walk starts and ends at St. Brides and includes a guided section from Paul's Cross in St Paul's churchyard to West Smithfield. The route is on mainly level ground, the exceptions being some steps in St Bartholomew the Great churchyard and the walk up Ludgate Hill. <i>(Max 20 participants)</i></p> <p>Chris came to live and work in London in the early 1980s and has been hooked on the capital city ever since. She loves to share her knowledge of the city with both visitors and fellow Londoners – even those who live here are amazed by the places and stories she can reveal to them! A History graduate and a former teacher, she is now a qualified City of London, City of Westminster and London Borough of Camden tour guide. She leads tours at weekends and throughout the week, on a variety of themes. She is happy to accommodate a range of age groups on her tours – from primary age children to grandparents.</p>