

# Monumental Inscriptions

The Church of St Luke  
Newton Harcourt, Leicestershire

Transcribed by  
Members of the Family History Group of  
Great Glen USA



Compiled by Jane Moelwyn-Hughes and Toni Smith  
Photographs by Toni Smith  
Produced with kind permission of Revd P. J. O'Reilly  
© June 2008

## **Index of Contents**

Page 2	About this project
Page 3	A few notes about Newton Harcourt
Page 4	A brief history of the Church of St Luke, Newton Harcourt
Page 5	The little church gravestone.
Page 7	Plan of the graveyard – showing the sections and numbered graves
Page 8	Aerial view of St Luke's church and graveyard
Page 9 – 12	Photographs of the church and graveyard
Page 13	Guide to types of monuments and Section A Inscriptions
Page 16	Section B Inscriptions
Page 18	Section C Inscriptions
Page 19	Section D Inscriptions
Page 21	Section E Inscriptions
Page 24	Section F Inscriptions
Page 25	Other Inscriptions
Page 26	Index of all names that occur on monuments in and around the church of St Luke, Newton Harcourt.

## **About the Project**

The recording of the monumental inscriptions inside and outside the church was undertaken by members of the Family History Group of Great Glen U3A. All care has been taken to ensure accuracy of the transcription, however a visit to the church or churchyard to check with the original inscriptions is recommended.

Words from some inscriptions were unable to be read for reasons such as broken stones, writing worn away through time etc., and so some blank spaces may occur in the transcriptions. The aim was to record the words exactly as they are found on the stone – so variations in spelling are a common occurrence.

Some of the very old graves were transcribed and published in 1798 in a book called *'The History and Antiquities of Leicestershire'* by John Nichols and this can be seen at the County Record Office. Where the script was found to be unreadable, a few words may have been taken from these transcripts and identified in [] brackets to help the researcher.

These recordings are also posted on the Leicestershire Villages Web Site – under the village of 'Newton Harcourt'.

**© Copyright 2008 – Great Glen U3A**

**Book compiled by Jane Moelwyn-Hughes and Toni Smith**

**No part of this document may be reproduced in any form without the prior permission of the authors**

## **Newton Harcourt**

***John Nichols – ‘The History and Antiquities of the County of Leicester’ Vol II  
Published 1798***

Newton Harcourt was so called from the Harcourts, some time lords of it. It is a hamlet of the parish of Wistow, and is bounded by Wistow, Kilby, Great Wigston and a small part of Oadby and Great Glen. The spelling was originally Newetone and in 1240 the village was, by Saher de Quincy, earl of Winchester, given in marriage with Arabell his daughter to Sir Richard de Harcourt, knight and in the testa de Nevill, Newton is described as containing eight ploughlands of the fee of Harcourt.

In the itinerary of 1280, Newton, Fleckney, Wistow and Sadington answered collectively as one village.

In 1483, William lord Hastings died seized of the manor and lordship of Newton Harcourt; also of two messuages, two virgates of land, two acres of meadow, four acres of pasture and 4s rent in Newton Harcourt, and from him it descended to the earls of Huntingdon.

The freeholders here who polled in 1630 were Francis Chamberlaine, William Bright, John Gilbert and William Dawes.

In 1719 and 1722, five freeholders polled; and six in 1775.  
John Chamberlaine was lord of this manor in 1642.

The earl of Denbigh (in right of his lady) is lord of the manor and the principle land owner. Mr Woodruffe, of Burton, has also a good estate here; and there are some other smaller proprietors.

The chapel and one large old house stand very near, and on the south side of the Navigation, called The Union Canal; the other part of the village is on the North side the canal, to which there is a communication by a modern bridge of brick. The chapel and house before mentioned are situated between the navigation and the little river Sense, at a very small distance from each.

***Arthur Mee ‘The King’s England’ – Leicestershire and Rutland – Newton Harcourt  
Published Sept 1948.***

Newton Harcourt – In a valley stand its oldest neighbours, an attractive Elizabethan manor house and a church which was given a new lease of life last century and has lost most of its ancient aspects and possessions. In the shady churchyard is a striking modern monument in the form of a miniature church with spire, porch, windows, and battlements, set up in memory of a boy of eight, a little shrine not unlike a toy building he himself might have tried to fashion with a big box of bricks. We have come upon no other like it in any of our country churchyards.

*(see page 5 for the story of this gravestone)*

## **The Church of St Luke, Newton Harcourt.**

*The following account is taken from a leaflet to be found in the church  
With kind permission of Father Philip O'Reilly, SSC*

The church achieved its present form in the 13<sup>th</sup> century and consists of a nave and west tower. This reflects the origins of the building as a chapel of ease. The upper half of the tower is built in ironstone whilst the older, lower part is rounded stones which may have been taken from the river.

The doorway dates back to the 15<sup>th</sup> century. In 1619, general repairs were carried out and the church was re-painted. The church door and pews were repaired in 1626.

The pulpit dates back to 1777, as does the reading desk and communion rails. At this time, the old font was demolished, and a small modern one introduced.

John Nichols, in 1798, in his '*The History and Antiquities of the County of Leicestershire*' (Vol II) wrote of Newton Harcourt church: -

*'Mr Burton notices one coat [of arms] in this chapel, which is now gone.  
On the wall on the North side the nave is painted [the inscription] 'The gift of Samuel Ward to the poor of Newton Harcourt, yearly, sixty pennyworth of bread'. There are no interments here'.*

New seats were installed in 1784.

In 1797, weatherboard was added in the belfry, and at that time also repairs were carried out to the roof. Further repairs were carried out in 1832, when new fittings and furniture were installed and two years later, in 1834, the gallery was erected in the lower part of the tower, followed in 1838 by a brick recess for the north door and a brick vestry.

In 1874, further renovations saw the gallery over the lower part of the tower removed, and it was in 1876 that the burial ground was consecrated. It was at about this time that burials ceased at Wistow.

The organ, originally from Wistow Hall, was installed into the church in 1899.

Other restorations that occurred were one bell and glass windows. In 1992 the organ was overhauled and repaired. The previously installed bell was taken down and repaired and a new wooden frame and supports for the bell were repaired at a cost of over £3,000 by Taylors of Loughborough, in 2004.

The only inscription we could find in the church was a small brass plaque on the organ which reads: -

To the Glory of God and in most loving memory of E. URSULA HALFORD who loved and adored this church. This organ formerly at Wistow Hall is restored and placed here by her nearest relations A.D.1899

## **The Little Church Gravestone**

**(A father's tribute to his son).**

In the churchyard at Newton Harcourt can be found a gravestone carved in the shape of a little church. It was carved by George Gardner, for his son Christopher. Using information from the family and records found at the County Record Office, the story of the Gardner family unfolds.

George Gardner, who made the gravestone, was born in Chelsea, London c1882, the second son of George Gardner and Sarah Jane Jewell. George senior was a stonemason and his son followed in his father's footsteps. George married his cousin, Nellie Jewell, c1902 in London and by 1912 seven children had been born to them.

George Gardner, a stone mason by trade, left his family in London to fight in France in WW1. He suffered badly from the effects of gas and on returning to England was sent, by the army, to Wistow Hall to convalesce. He was befriended by Lord Cottesloe, who employed him as a clerk. Lord Cottesloe suggested that George should bring his wife and seven children from London to live in Leicestershire and offered to find them accommodation in Newton Harcourt. George accepted the offer, and the family arrived in 1916. On 22 May 1916, six Gardner children were admitted to Newton Harcourt School. The family expanded rapidly and soon outgrew their first home. They moved to two cottages in Long Row, Newton Harcourt, which had been knocked into one. School records for Newton Harcourt School, show that a further eight Gardner children were admitted between 1917 and 1932.



**George Gardner**



**The Gardner Family**

The little church gravestone is for George and Nellie Gardner's eighth child, Christopher Victor, who was born on 26 August 1916 and died aged 8 on 20 September 1924. There are two accounts of how and why the gravestone came to be made, both supplied by Nellie Louisa, Christopher's sister. The first is the inscription on the reverse of a photograph of the gravestone, written in 1994, which states: -

*"George Gardner made this little church because Chris always used to say when he grew up he'd have his own church*

*(he meant he was going to be a vicar). However, he died at 8 years old because of Scarlet Fever. The next grave to it is my Dad's. My brother Charles had it made as the first one got broken.- - -"*



## The Church of St Luke, Newton Harcourt

George Gardner remembered that remark. It prompted him to order a large block of stone and he set to work making a miniature church, some five feet high at the top of the steeple.

He worked on it each day when he got home from his job. A true labour of love, carried out in the backyard of the family cottage in Long Row, Newton Harcourt. When the miniature church was complete, he and his workmate took it to the churchyard on a wheelbarrow and erected it.

Another of George and Nellie's children is also buried nearby. Florence Elizabeth, who was their youngest child, was tragically killed in an accident on London Road, Leicester when she was knocked off her bicycle by a lorry.

Further research at the Record office, revealed the baptisms of all seven of the Gardner children born in Newton Harcourt and looking in the admissions book of Newton Harcourt School, was found the names of the fourteen children, including of course Christopher and Florence Elizabeth.

George Gardner became an Inspector of Pavements for Leicester City Council and died in the 1940s. But it is for his skill as a stonemason that he will be remembered. He has ensured that the Gardner family will always be thought about, when visitors to Newton Harcourt churchyard gaze at the memorial and wonder why and how Christopher Gardner came to have such a beautiful and unusual gravestone.

**This article was written by Liz Adams, a member of the Great Glen U3A Family History Group, with the help, consent and thanks to Paddy Letts and her mother Nellie Louisa Reynolds, nee Gardner, and also the staff of the Leicestershire Record Office.**



# **Plan of the Churchyard** showing the areas and the numbered graves

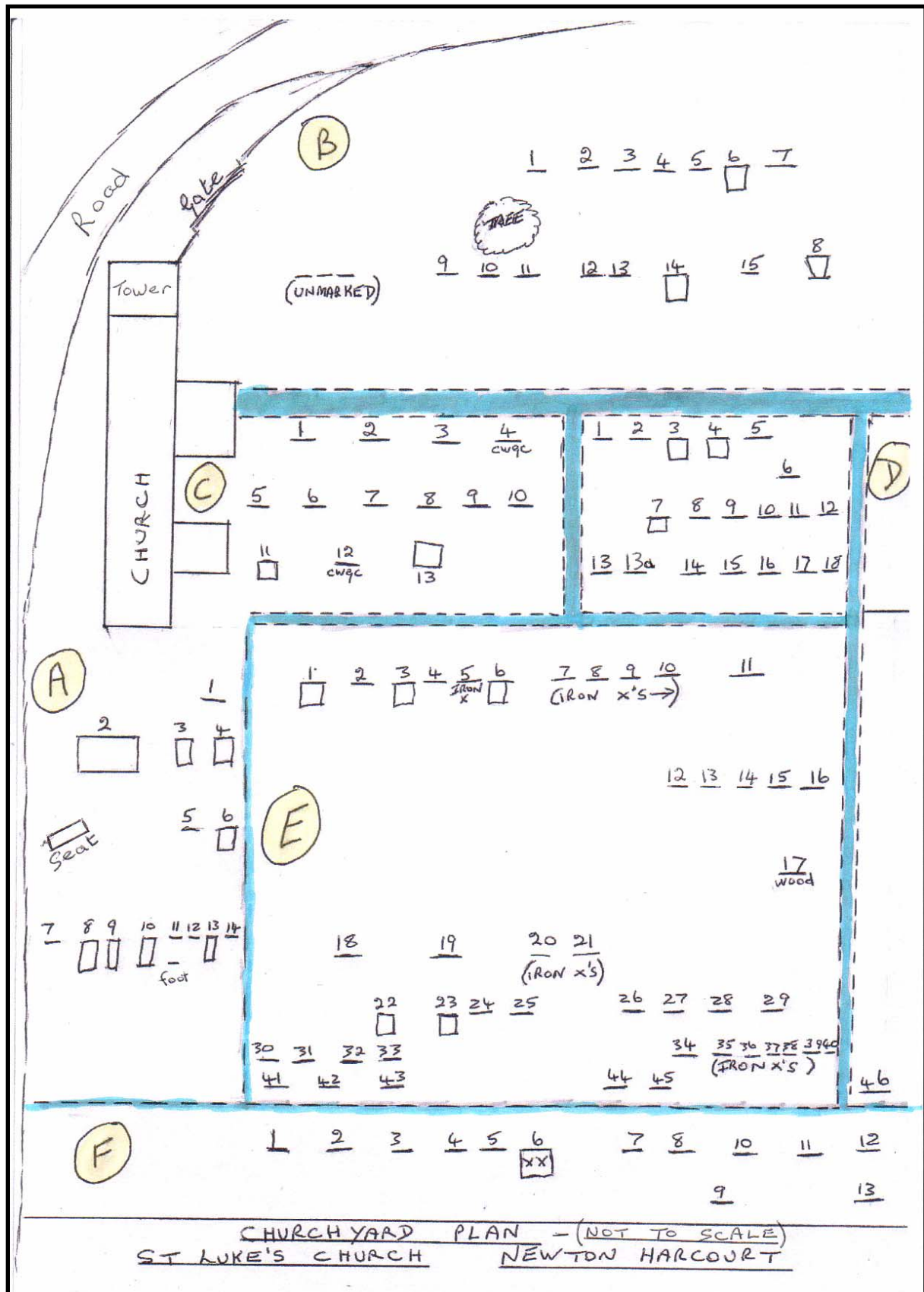



**Newton Harcourt**  
**The Church of St Luke**





## The Church of St Luke, Newton Harcourt



**The seats date from 1784**

**The Organ, originally from Wistow Hall, was installed in 1899.**



**The Font dates from 1777**

## The Church of St Luke, Newton Harcourt

The brick recess for the north door was built in 1838

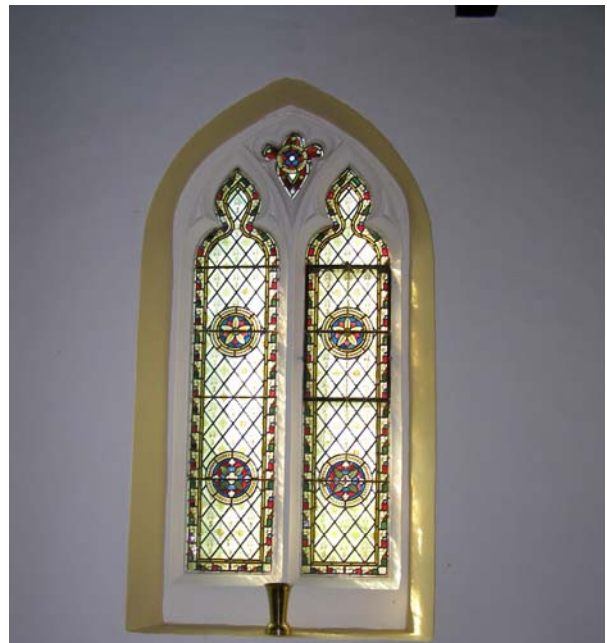
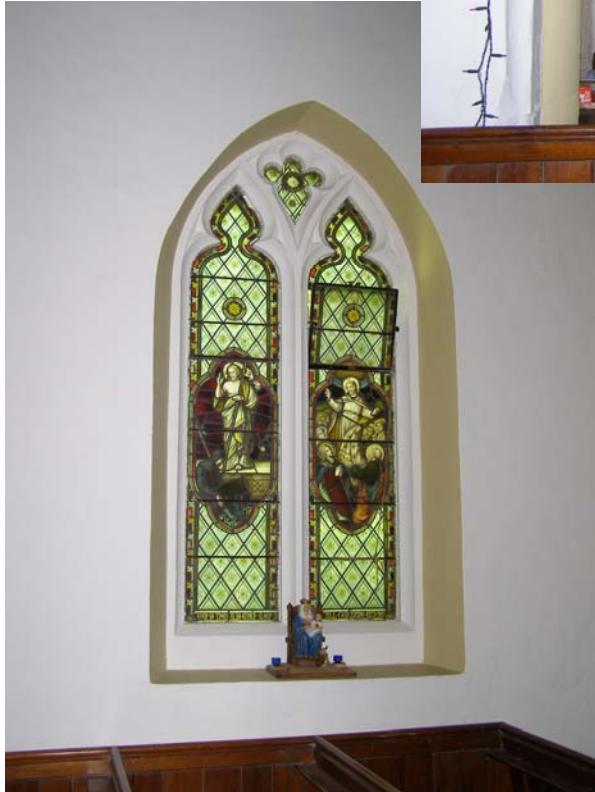



## The Church of St Luke, Newton Harcourt





## The Church of St Luke, Newton Harcourt



## Monumental Inscriptions in the Churchyard

The following is a guide only to the description of the type of monument described in this booklet. - We are not geologists, and this is our best guess!

Key	Description
BMHS	Black marble headstone
CWG	Commonwealth War Grave
GMHS	Green/grey marble headstone
MC	Marble cross
MHS	Marble headstone
MP	Metal plaque
SC	Stone Cross headstone
SFS	Stone foot stone
SHS	Stone headstone
SLHS	Slate headstone
STFV	Small stone flower vase
WC	Wooden cross
WMHS	White marble headstone

### Section A

No	Inscription	Type/Mason
A1	In loving memory of HENRY WHISTON who died Dec 18 <sup>th</sup> 1929 aged 73 "Nothing in my hand I bring/Simply to Thy cross I cling" also MARY ELIZABETH wife of the above who died July 19 <sup>th</sup> 1948, aged 84 At Rest	SHS
A2	Sir HENRY St JOHN HALFORD Baronet born 9 Aug 1828 died 4 Jan 1897 and Dame ELIZABETH URSULA his wife born 27 Oct 1829 died 30 Jan 1897 "Until the day break and the shadows flee away"	Marble tomb with kerb
A3	The Rev Sir JOHN FREDERICK HALFORD Bart Rector of Draughton died April 7 1897 aged 67	SHS
A4	HENRY ARTHUR BROWETT 1886-1951 and his wife CLARA ELLEN 1888- 1977	GMHS flat Fishers Ltd Waterloo Street Lester
A5	In loving memory of CHARLES BRYAN WARD who died Nov.7 1896 age 50 yrs also MAY daughter of the above who died Nov 14 <sup>th</sup> 1896 aged 18 yrs. Also ELIZABETH ELLEN wife of the above who died Feb 29, 1932 aged 87 years "Peace Perfect Peace" CHARLES BRYAN WARD 1909-1997 A loving husband and father and grandfather	GHS  Brass Plaque W Thrall Lester

# The Church of St Luke, Newton Harcourt

No	Inscription	Type/Mason
A6	<p><b>Right side</b> In loving memory of HENRY LANGTON GODDARD J.P.M.A. (Oxon).F.R.I.B.A. Architect of Leicester Born 9<sup>th</sup> July 1866 died 4<sup>th</sup> March 1944</p> <p><b>Middle right side</b> ALEXANDER GODDARD C.B.E 2<sup>nd</sup> son of JOSEPH and ANNIE 17<sup>th</sup> Oct 1867-12<sup>th</sup> Dec 1956 Secretary of The Institution of Chartered Surveyors, London married ELLEN H ILLINGWORTH 1901</p> <p><b>End right side</b> And of his wife GERTRUDE PHILLIPS GORDON GODDARD born 6<sup>th</sup> June 1876 died 3<sup>rd</sup> September 1949</p> <p><b>Head</b> In loving and affectionate memory of SYLVIA HARRIET GORDON GODDARD born 5<sup>th</sup> Jan 1905 died 5<sup>th</sup> June 1984 Universally loved, she spread faith healing and literacy among the peoples of Southern Africa and reorganised libraries in Scotland and Israel with humour and energy. As a devoted friend and relative sorely missed by all “Resurgat”</p> <p><b>Left side</b> In loving memory of Group Captain HENRY GORDON GODDARD Royal Air Force D.S.O.,D.F.C, A.F.C, F.R.I.B.A Died 13.11.72 aged 64</p> <p><b>Middle left side</b> In loving memory of JOSEPHINE MARY WALMSLEY 2<sup>nd</sup> daughter of JOSEPH &amp; ANNIE GODDARD who died in Kenya July 20. 1928 aged 55 years “Brave”</p> <p><b>Top</b> I H S (insignia) In loving memory of JOSEPH GODDARD of the Manor House Newton Harcourt J.P. F.R.I.B.A. F.S.I renowned in his profession more particularly for his ecclesiastical &amp; domestic works. Beloved by all who knew him for his singleness of heart &amp; unfailing tact and kindness. He died Oct 10<sup>th</sup> 1900 in his 61<sup>st</sup> year Resurgat Also of ANNIE his wife who died at Binton Cottage Farnham Surrey on Christmas Day 1933 in her 95 year and is buried here Full of years honoured &amp; beloved</p> <p><b>Foot</b> J.G</p>	Large Slate Sarcophagus Tomb with wooden kerb
A7	<p>Per Ardua Ad Astra In memory of GEORGE HERBERT ALDRIDGE Pilot Officer R.A.A.F. beloved second son of the late JOHN BARTTELOT ALDRIDGE D.S.O., R.H.A.&amp; MARGARET his wife who was killed flying near Great Glen Sept 2<sup>nd</sup> 1928 aged 26 “ I bear you on eagles’ wings &amp; brought you unto myself” and in loving memory of his mother MARGARET JESSICA LLOYD nee GODDARD Born 1888 died May 19<sup>th</sup> 1941</p>	SLHS with RAF Insignia
A8	<p>HARRIET CRAVEN died Nov 19<sup>th</sup> 1945 aged 78 years At rest</p>	G kerb stone
A9	<p>MABEL LEVESLEY Died July 28<sup>th</sup> 1938</p>	Small SHS
A10	<p>In memory of ELIZABETH wife of GEORGE GRAY born March 9<sup>th</sup> 1829 died June 4<sup>th</sup> 1902. Peace Perfect Peace</p>	SHS flat



## The Church of St Luke, Newton Harcourt

No	Inscription	Type/Mason
A11	In affectionate remembrance of GEORGE GRAY who died June 5 <sup>th</sup> 1877 aged 57 years. Be ye therefore always ready Stone foot stone G.G.1877	GHS  Mason Kibworth
A12	God is Love In loving memory of ELIZABETH COLEMAN who departed this life May 13 <sup>th</sup> 1882 aged 92 years Looking unto Jesus	SHS
A13	In grateful memory of THOMAS FRANCIS DEACON of Kilby Lodge. Born at Cadeby March 16 <sup>th</sup> 1869 died January 18 <sup>th</sup> 1932 and his wife HILDA CLUER DEACON Born August 24 <sup>th</sup> 1872 died October 6 <sup>th</sup> 1964	Large rough granite headstone & kerb
A14	In loving memory of ETHEL R FRECKELTON the dearly loved wife of SYDNEY FRECKELTON who died 14 <sup>th</sup> July 1954 aged 73 years also SYDNEY FRECKELTON who died 10 <sup>th</sup> January 1961 aged 84 years.	SLHS

### Section A



(A6 on the left by the tree)



## Section B

No	Inscription	Type/Mason
B1	ANNE SAUNDERS 1948-1993 aged 44 years “Death is nothing at all./ I have only slipped away into the next room” “Think of me, pray for me”	Stone slab
B2	In loving memory of DAVID HOWARD died 20 <sup>th</sup> June 1991 aged 28 years	Stone slab
B3	WILLIAM J NEWTON 1916-1989, his wife ETHEL M NEWTON 1917-2001 Together again	Marble plinth
B4	In loving memory of BARBARA SCHWAUSCH . Born 11 <sup>th</sup> July 1935 Died 31 <sup>st</sup> Jan 1989 “Forever in our thoughts”	Marble plinth
B5	<b>Left</b> In loving memory of FLORENCE EDITH MOORE (Flossie) Born March 7 1911 Died July 9 1980 “Rest in Peace” <b>Right</b> Also her beloved husband GEORGE PURDY MOORE Born Nov 29- 1899 Died May 23 -1994 Re united	Stone book
B6	In loving memory of THOMAS WITHERS who died January 8 <sup>th</sup> 1900 in his 81 <sup>st</sup> year also of SARAH ANN wife of THOMAS WITHERS who died Aug 29 1897 aged 76 years For, if we believe that Jesus died/And rose again, even so them/ .Also which sleep in Jesus will/God bring with Him. 1 Thessalonians IV. Chap.14 verse	Stone with kerb  F.Cox Wigston
B7	In ever loving memory of GEORGE RHYDERO BACNALL who fell asleep 1 <sup>st</sup> March 1897 aged 43 R.I.P. “Til the day beak and the shadows flee away” and of ANN MARGARETTA his wife who passed peacefully away in London 14 <sup>th</sup> Dec 1937 aged 87 “To live in the hearts of those we leave behind is not to die” <b>Right side</b> To the memory of GWEN the eldest daughter died in Canada 5 <sup>th</sup> Nov 1938 aged 55, OTTO RHYDERO eldest son died on War Service 10 <sup>th</sup> Oct 1941 aged 55 <b>Left side</b> To the proud memory of Capt WYNN BACNALL M.C.CFA, youngest son who died in New York 7 <sup>th</sup> mar 1931 from illness contracted in the Great War 1914-1918 aged 41	3 tiered broken marble cross with railings around
B8	In loving memory of TREVOR E TOMSON beloved husband and father died March 14 <sup>th</sup> 2004 aged 71 years Memory is a golden chain that binds us til we meet again TREVOR EDWARD TOMSON died 14 <sup>th</sup> March 2004 aged 71 years	BMHS  Plaque

## The Church of St Luke, Newton Harcourt

No	Inscription	Type/Mason
<b>B9</b>	<p><b>Left side</b> In loving memory of CHARLES ROBERT MARTIN died 13<sup>th</sup> June 1949 aged 72 years, AMY GRACE MARTIN died 5<sup>th</sup> April 1951 aged 77 years</p> <p><b>Right side</b> ETHEL MAUD MARTIN died 16<sup>th</sup> Jan 1975 aged 66 years also in memory of a loving daughter sister and auntie HETTIE MARTIN 1910-1983</p> <p><b>Left kerb</b> ANNA SARAH MARTIN who died January 7<sup>th</sup> 1927 aged 47 years</p> <p>Right kerb DEREK CHARLES MARTIN who died January 12<sup>th</sup> 1930</p> <p><b>Front kerb</b> Not Forgotten</p>	Stone open book with slate kerb
<b>B10</b>	In loving memory of JAMES WILLIAM DODSON died March 2 <sup>nd</sup> 1965 aged 79 and ALICE his dearly loved wife died July 25 <sup>th</sup> 1972 aged 84 and MARGARET NANCY DODSON beloved daughter of the above died October 1925 aged 5	GMHS
<b>B11</b>	No inscription	SV
<b>B12</b>	In loving memory of THOMAS THOMPSON who died October 28 <sup>th</sup> 1889 aged 88 years Blessed are the dead which died in the Lord	SLHS E Hassell Wigston
<b>B13</b>	Treasured and precious memories DAISY and EWART SHAW loving parents, grandparents and great grandparents. DAISY died 11.7.99.aged 81, EWART died 14.12.99 aged 84 They will always be in our hearts	BMHS
<b>B14</b>	In loving memory of ROBERT RICHARDS Born at Barrow on Soar Sept 22 <sup>nd</sup> 1843 died at Newton Harcourt Nov 26 <sup>th</sup> 1915 also of SARAH JANE beloved wife of the above died at Newton Harcourt Jan 18 <sup>th</sup> 1937 in her 86 <sup>th</sup> year	SC with kerb
<b>B15</b>	In loving memory of RICHARD HARRISON who died November 11 <sup>th</sup> 1905 aged 59 years also ANNE wife of the above who died Jan 27 <sup>th</sup> 1946 aged 98 years	WMHS C Southorn Woodgate Lester

**Section B of the churchyard**





## Section C

No	Inscription	Type/Mason
C1	In loving memory of GEORGE GARDNER maker of his son's, CHRISTOPHER'S little church which stands here Died 28 Jan .43 aged 61 years also his beloved daughter FLORENCE ELIZABETH died 15 Oct .43 aged 16 years	SHS
C2	To the fragrant memory of CHRISTOPHER V GARDNER born 26 Aug 1916 died 20 Sep't 1924 aged 8 years	Stone church
C3	LESLIE WILLIAM BERRY 25 <sup>th</sup> May 1920-8 <sup>th</sup> November 1998 Dearly loved husband father and grandfather , BEATRICE FLORENCE BERRY 10 <sup>th</sup> May 1921-21 <sup>st</sup> August 2002 dearly loved wife mother and grandmother Rest in Peace	BMHS
C4	J.A.ROBINS Stoker 1 <sup>st</sup> Class R.N. K/50283 H.M.S. "Pembroke" 30 <sup>th</sup> December 1919	CWG
C5	In loving memory of MARY ANN HOLMES who died May 24 <sup>th</sup> 1890 aged 49 years. From her loving son "Rest in the Lord"	GHS C Collin 28 London Rd Le'ster
C6	In loving memory of ALBERT HENRY BOWN died 18 <sup>th</sup> Nov 1940 aged 82 years HENRIETTA BOWN died 5 <sup>th</sup> March 1947 aged 89 years	Stone kerbstone
C7	In loving memory of LAVINIA widow of the late JOSEPH BRUNSKILL of Newton Harcourt who died March 1 <sup>st</sup> 1915 in her 81 <sup>st</sup> year Peace Perfect Peace	SHS  Fisher
C8	In loving memory of SAMUEL PANTER DICKENS of .....died November ...1886 aged 62 years  (surface very worn)	SHS Knight Station St Leicester
C9	In loving memory of ALBERT ERNEST SMART who passed away Nov 29 <sup>th</sup> 1921 aged 55 years also MARGARET SMART widow of the above who died December 11 <sup>th</sup> 1959 aged 92 years "To live in the hearts of those who love us is not to die"	SLHS
C10	In loving memory of HILDA MARGARET SMART died 12 <sup>th</sup> Jan 1966 aged 67 yrs also her brother WILLIAM EDGAR SMART died 10 <sup>th</sup> Oct 1976 aged 80 years	GHS
C11	In loving memory of ANDREW WILLIAM HURST who died July 27 <sup>th</sup> 1940 aged 81 years also his beloved wife SARAH ANN HURST who died Oct 18 <sup>th</sup> 1936 aged 84 years "At rest"	SLHS with kerb H V B Ltd
C12	Cornwalls 200218 Private T.P.OWEN Duke of Cornwall's L.I. 28 <sup>th</sup> February 1919 aged 30 Though death divides fond memories cling ETHEL and the girls	CWG
C13	In loving memory of a dear wife and mother MABEL DODSON who departed this life March 4 <sup>th</sup> 1944 aged 55 years also my dear father HORACE DODSON died February 25 <sup>th</sup> 1909 aged 79 years	SKS

## Section D

No	Inscription	Type/Mason
D1	REBECCA STEINTHAL nee MEYER Tante Becca Born 3 <sup>rd</sup> October 1862 at Hanover died 21 <sup>st</sup> July 1953 at Wistow	GHS
D2	ELIZABETE LEMANIS 1884-1951 ANNA SMITS 1898-1957 Act 14.22	GHS
D3	In loving memory of THOMAS HENRY CLARK died August 1 <sup>st</sup> 1935 aged 60 years also of VIOLET JESSIE beloved daughter of the above died May 7 <sup>th</sup> 1914 aged 13 years Peacefully sleeping resting at last/The world's weary troubles and trials are past/In silence you suffered in patience you bore/ Til God called you home to suffer no more	BMHS  Ireson Kettering
D4	No inscription seen	Large SHS face down
D5	IGNOTUS EXAQUIS 28.V.1936 ORA PRO ANIMA	SLHS broken in half
D6	In loving memory of a dear wife and mother LILIAN ALICE OAKEY died Jan 26 1984 aged 54 also her husband FREDERICK OAKEY died Nov 11 <sup>th</sup> 1988 aged 74 Small vase-In loving memory	GMHS
D7	In loving memory of a dear wife and mother GLADYS IRENE WOOLLEY born 11.7.1915-died 29.6.1965 aged 49 years also her husband ARTHUR HENRY WOOLLEY born 11.9.1912-died 12.4.1992 aged 79 years Small vase- MARGARET SIMKIN nee (WOOLLEY) 1941 -2001 devoted wife and mother	WM kerbstone
D8	In loving memory	Small vase
D9	No inscription	Iron marker No 10
D10	In loving memory of SAMUEL son of RICHARD and ANNIE BENT born July 16 <sup>th</sup> 1895 died April 26 1905 Thy will be done R.I.P	SC
D11	<b>Left side</b> In loving memory of RICHARD BERNARD BENT died 25 July 1974 aged 81 years At Rest  <b>Right side</b> Also his beloved wife GLADYS MAY BENT died 20 <sup>th</sup> July 1987 aged 89 years Re-United	GM Open book
D12	In memory of ALICE ELIZA WOOD died June 11 <sup>th</sup> 1975 aged 72 also her beloved husband JOHN died Sept 20 <sup>th</sup> 1977 aged 75	SHS
D13	EMILY GODDARD died 11 <sup>th</sup> Jan 1970 also her husband RALPH died 11 <sup>th</sup> Jan 1973	M Kerbstone

## The Church of St Luke, Newton Harcourt

No	Inscription	Type/Mason
<b>D13a</b>	In loving memory of HAROLD BOULTER died Jan 22 <sup>nd</sup> 1961 aged 62 years and DOROTHY LILIAN BOULTER died Mar 24 <sup>th</sup> 1973 aged 68 years	SLHS flat
<b>D14</b>	In loving memory of HANNAH TWIGG 1883-1974	MHS
<b>D15</b>	Treasured memories of ERNEST DAVID MATTOCK a beloved husband father and grandpa died 26 <sup>th</sup> march 1979 aged 65 years also MINNIE MATTOCK his devoted wife died 1 <sup>st</sup> Sept 1983 aged 65 years Re-united	MHS G Collin Leicester
<b>D16</b>	In loving memory of a dear husband & father REGINALD GEORGE DIXON died 7 <sup>th</sup> Feb 1981 aged 74 years also ALICE MARY DIXON died 6 <sup>th</sup> August 1982 aged 79 years father Small vase- ROGER DIXON in loving memory 29.7.41-21.12.97	BMHS
<b>D17</b>	In loving memory of RONALD ROSS who died on 5 <sup>th</sup> November 1981 Dearly loved husband of JO	SHS
<b>D18</b>	In loving memory of LEONARD CHARLES JARMAN 5.2.1905-2.2.1983 MABEL DORIS JARMAN 8.6.1907-25.12.1982 Small marble vase LEONARD CHARLES JARMAN 1905-1983 MABEL DORIS JARMAN 1907-1982	SLHS  Peter Herbert Syston Leicester

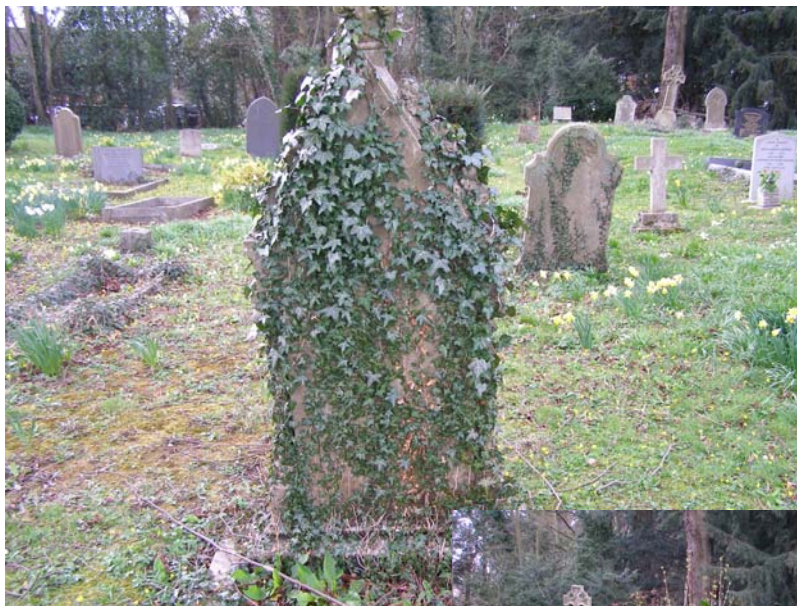

**Graves were not all easy to transcribe!**

**Iron cross markers**



## Section E

No	Inscription	Type/Mason
E1	To the dear memory of my beloved husband SYDNEY BALE died Sept 8 <sup>th</sup> 1963 aged 55 years also his dear wife ANNE MAY BALE died Jan 10 <sup>th</sup> 1994 aged 83 years Reunited	Polished GHS with kerb
E2	In loving memory of JOHN BECKETT JOHNSON (husband & father) CARREGWEN LOUVAINE JOHNSON nee JONES wife & mother WILLIAM JOHNSON son Stone vase-In loving memory	Slate slab
E3	In loving memory of ROSE MARIA WATERTON died March 2 <sup>nd</sup> 1960 aged 71 also JOSEPH husband of ROSE died March 10 <sup>th</sup> 1972 aged 85 Rest in Peace	Stone kerb
E4	No inscription	Small Vase
E5	No inscription - 12	Iron marker
E6	In loving memory of SARAH MAY CLARKE died Aug 17 <sup>th</sup> 1962 aged 87 years EDWIN CLARKE died Nov 28 <sup>th</sup> 1978 aged 80 years MAURICE G CLARKE died Aug 5 <sup>th</sup> 1934 aged 15 months MARGARET GENA CLARKE died Sept 6 <sup>th</sup> 1938 aged 14 years	GHS with kerb
E7	No inscription - 11	Iron marker
E8	No inscription - 16	Iron marker
E9	No inscription	Iron marker
E10	No inscription	Iron marker
E11	In loving memory of DAVID GEORGE INGHAM 1915-1974 also his wife GWENDOLINE MARY INGHAM 1921-2004. Their son in law TONY LEE 1940-2005	SHS
E12	<b>Front</b> ANNIE MARIA SCOTCHBROOK died Dec 17 <sup>th</sup> 1945 aged 85 years <b>Back</b> EMMA LOUISE SCOTCHBROOK died 13 <sup>th</sup> Dec 1976 aged 87 years	Stone vase
E13	<b>Left</b> JOHN W WYATT 22 <sup>nd</sup> dec 1961 aged 79 yrs <b>Right</b> GERTRUDE A WYATT 10 <sup>th</sup> Feb 1979 aged 93 years <b>Back</b> DAVID GEORGE INGHAM died 27 <sup>th</sup> Jan 1974 aged 58 years <b>Plaque in front</b> ALBERT EDWARD ANTHONY LEE died 20 <sup>th</sup> December 2005 aged 65 years	Stone Vase



# The Church of St Luke, Newton Harcourt

No	Inscription	Type/Mason
<b>E14</b>	In loving memory of GEORGE ELLINGWORTH <b>Plaque</b> PATRICIA ANN ROBERTS 1938-2006 <b>Left</b> ALBERT ROBERTS Born 1 <sup>st</sup> July 1912 Died 18 <sup>th</sup> July 1998 <b>Front</b> PATRICIA ROBERTS born 19 <sup>th</sup> Sept 1938 died 15 Oct 2006 <b>Right</b> PHYLLIS ROBERTS born 11 <sup>th</sup> Jan 1912 died 6 <sup>th</sup> July 1973	Marble vase
<b>E15</b>	In memory of my dear husband GREGORY H.E. NOBBS 1913-1990 Au revoir NORA NOBBS nee ISON 1926-2003 Je ne regrette rien	SHS  G Collin
<b>E16</b>	In loving memory of our dear brother PAUL CHARLES JARMAN 4.1.1968-29.5.1989	BMHS
<b>E17</b>	NORA NOBBS died 8 Jan 2003 aged 76 years	Wooden Foot marker of E15
<b>E18</b>	In loving memory of ANNIE DUNMORE died July 28 <sup>th</sup> 1946 aged 69 years “Until we meet again”	Granite vase with slate front
<b>E19</b>	In loving memory SARAH HAYWARD who died March 5 <sup>th</sup> 1889 aged 50 years Safe in her Saviour’s keeping/Who sent her calm release/T’is only we are weeping/She sleeps in perfect peace	Stone Cross
<b>E20</b>	No inscriptions	Iron cross
<b>E21</b>	No inscriptions	Iron cross
<b>E22</b>	FLORENCE GREGORY died Sept 20 <sup>th</sup> 1948 aged 61 years. At Rest	Stone kerb
<b>E23</b>	In loving memory of FRANK MAJOR died 21 <sup>st</sup> Feb 1949 aged 71 years also of MARION wife of above died 9 <sup>th</sup> Oct 1956 aged 75 years Re-united “Safe in God’s keeping”	SHS with kerb
<b>E24</b>	In affectionate remembrance of CATHERINE widow of the late EDWARD WILLIAM KNIGHT who died June 3 <sup>rd</sup> 1884 aged 69 years “Blessed are the dead which die in the Lord”	SHS
<b>E25</b>	In loving memory of EDWARD THOMAS the beloved son of THOMAS & ANNIE LINGEN who died December 23 <sup>rd</sup> 1895 aged 9 years	Stone Cross (broken)
<b>E26</b>	In memory of our dear mother EMILY wife of GEORGE GEARY who departed this life July 7 <sup>th</sup> 1887 aged 47 years also of GEORGE GEARY who departed this life January 28 <sup>th</sup> 1907 aged 69 years and was interred at Ratby and two of their children FANNY & WILLIE who died in infancy “If we suffer, we shall also reign with Him”	SLHS  C Wesley
<b>E27</b>	In affectionate remembrance of THOMAS HARROLD FREESTONE born July 14 <sup>th</sup> 1810 died April 28 <sup>th</sup> 1888 Yea though I walk through the valley of the shadow of death/I will fear no evil/For thou art with me/Thy rod and staff they comfort me	SHS  J B

# The Church of St Luke, Newton Harcourt

No	Inscription	Type/Mason
<b>E28</b>	In affectionate remembrance of HARRIETT wife of THOMAS HARROLD FREESTONE who died July 12 <sup>th</sup> 1885 aged 77 years “My help cometh of God” Psalm VII.12v	SHS J Butteriss
<b>E29</b>	In loving memory of MARY ELIZABETH widow of the late JOSEPH TURNER (of Newton Harcourt) died February 28, 1888 aged 71 years “Thy will be done” Also of ELLEN ELIZABETH TURNER daughter of the above died December 13, 1916 aged 66 years Death is the messenger of peace/And calls the soul to heaven	PMHS W T Jee Leicester
<b>E30</b>	FLORENCE EMILY SHEPPARDS died 1 <sup>st</sup> August 2006 aged 89 years  Vase – In loving memory	Wooden plaque with black marble kerb
<b>E31</b>	Memories Mother & Dad At Rest	SV
<b>E32</b>	In loving memory of JAMES H POTTS died ...Oct ...aged... Peace perfect Peace	SHS with kerb (very worn)
<b>E33</b>	In everlasting memory of a devoted Husband, Dad Granddad and Great Granddad ARTHUR SHEPPARDS died 21 <sup>st</sup> February 2005 aged 79 years In loving memory ARTHUR SHEPPARDS died 21 <sup>st</sup> February 2005 aged 79 years	BMHS SV Wooden plaque
<b>E34</b>	In loving memory of ELIZABETH MARY TYRRELL 21.9.1958 - 6.6.1994 also her father JOHN NORMAN TYRRELL 26.11.1914 – 19.7.1998	SHS
<b>E35</b>	No inscription - 3	Iron marker
<b>E36</b>	No inscription - 4	Iron marker
<b>E37</b>	No inscription - 6	Iron marker
<b>E38</b>	No inscription - 11	Iron marker
<b>E39</b>	No inscription - 13	Iron marker
<b>E40</b>	No inscription - 14	Iron marker
<b>E41</b>	In loving memory of GRACE MABEL COX who died 7 <sup>th</sup> May 1910 aged 32 years “Nearer my God to Thee”	SC with kerb C Southorn Les’ter
<b>E42</b>	In loving memory of JOSEPH WILLIAMSON who died July 30 1901 aged 70 years “At Rest” Also of ANN wife of the above died Nov 23.1924 aged 95 years	SHS with kerb F Cox Narborough
<b>E43</b>	In loving memory of ETHEL & ERNEST BRADSHAW aged 19 & 20 weeks	Small SHS
<b>E44</b>	In loving memory of MARY ANN PARKER who died November 8 <sup>th</sup> 1890 aged 83	SL cross

## The Church of St Luke, Newton Harcourt

No	Inscription	Type/Mason
<b>E45</b>	In loving memory of HENRY PARSONS who fell asleep August 14 <sup>th</sup> 1889 aged 64 years For 48 years lock keeper to the Old Union Canal Company. His last words were "I am only waiting the Lord's will"	SLHS  G Collin 28 London Rd Le'ster
<b>E46</b>	In loving memory of LILY VIOLETTA BROOK 1912 - 2005 and her beloved husband BENJAMIN HORACE BROOK 1916-2006. Loving parents of MARGARET and devoted grandparents. Loved and remembered always BENJAMIN HORACE BROOK died 22 May 2006 aged 90 years LILY VIOLETTA BROOK died 12 <sup>th</sup> June 2005 aged 92 years	SLHS  Metal plaque  Metal plaque

## Section F

No	Inscription	Type/Mason
<b>F1</b>	In loving memory of MARIA the beloved wife of THOMAS ALLEN who died August 22 <sup>nd</sup> 1878 aged 59 years also EDITH MARIA BRADSHAW who died Sept'r 9 1880 aged 9 weeks and JOHN EDWARD BRADSHAW who died Sept 16 1880 aged 1 year grandchildren of the above	SHS
<b>F2</b>	In loving memory of my dear wife OLIVE BRENDA LACEY died 24 <sup>th</sup> Oct 1983 aged 75 years also her beloved husband WILFRED HERBERT LACEY died 6 <sup>th</sup> Oct 1995 aged 82 years. Reunited	BMHS
<b>F3</b>	In loving memory of ANN COLEMAN who died October 22 1881 aged 77 years "Blessed are the dead which died in the Lord"	SHS
<b>F4</b>	In loving memory of SARAH JANE WOOLLEY born 6 <sup>th</sup> May 1883 died 21 <sup>st</sup> January 1959	Wooden cross with metal plate
<b>F5</b>	<b>Left side</b> In loving memory of WILLIAM WOOLLEY born Oct 24 1942 At Rest  <b>Right side</b> Of his wife BETSEY WOOLLEY born 3 Dec 1861 died April 11 1943 At Rest	Large wooden cross with side pieces
<b>F6</b>	<b>Right side</b> In loving memory of WILLIAM COOPER BURLEY who died Nov 7 <sup>th</sup> 1879 aged 59 years  <b>Left side</b> Until the day break In loving memory of SARAH wife of WILLIAM COOPER BURLEY who fell asleep May 22 <sup>nd</sup> 1902	2 S crosses in kerb
<b>F7</b>	Treasured memories of a dearly loved wife CONNIE SHEPPARDS died 21 <sup>st</sup> Nov 1997 aged 82 years also a devoted husband and father BERT SHEPPARDS died 5 <sup>th</sup> October 2006 aged 88 years	BMHS with stone kerb

## The Church of St Luke, Newton Harcourt

No	Inscription	Type/Mason
<b>F8</b>	JOAN MARY CLARKE died 23 <sup>rd</sup> February 2007 aged 79 years	Plaque
<b>F9</b>	JOHN M GREEN died 30 <sup>th</sup> Nov 2004 aged 76 years	Wooden cross with plaque
<b>F10</b>	<p><b>Front</b> In memory of THOMAS SNELL beloved husband father and grandfather died 18<sup>th</sup> March 2004 aged 61 years</p> <p><b>Back</b> TOM</p> <p>THOMAS JOSEPH SNELL died 18<sup>th</sup> March 2004 aged 61 years</p>	<p>MHS</p> <p>Wooden marker</p>
<b>F11</b>	WILLIAMS	Wooden marker
<b>F12</b>	JOHN DOUGLAS MARTIN died 13 <sup>th</sup> January 2006 aged 85 years	Plaque
<b>F13</b>	In loving memory of THOMAS TURNBULL 1937-2000	Marble vase

### Inside the Church

	Inscription	Type/Mason
<b>On The Organ</b>	To the Glory of God and in most loving memory of E.URSULA HALFORD who loved and adored this church. This organ formerly at Wistow Hall is restored and placed here by her nearest relations A.D.1899	Brass plaque
<b>Window sill in church</b>	<p>St Luke's Church, Newton Harcourt</p> <p>In memory of WILLIAM EDGAR SMART died 10<sup>th</sup> October 1976.</p> <p>Churchwarden 1922 – 1976</p> <p>This tribute was given by his friends in grateful recognition of his service to the community</p>	Brass vase

### Wooden Seat Sited in section A

	Inscription	Type
Wooden Bench Seat	In memory of THOMAS TURNBULL & Tarbie	



## Index of all the names that occur on the memorials at St Luke's Church, Newton Harcourt

Grave	Surname	Forename
A7	ALDRIDGE	George Herbert
A7	ALDRIDGE	John Barttelot
A7	ALDRIDGE	Margaret
F1	ALLEN	Maria
F1	ALLEN	Thomas
B7	BACNALL	Ann Margaretta
B7	BACNALL	George Rhydero
B7	BACNALL	Gwen
B7	BACNALL	Otto Rhydero
B7	BACNALL	Wynn
E1	BALE	Ann May
E1	BALE	Sydney
D10	BENT	Annie
D11	BENT	Gladys May
D10	BENT	Richard
D11	BENT	Richard Bernard
D10	BENT	Samuel
C3	BERRY	Beatrice Florence
C3	BERRY	Leslie William
D13a	BOULTER	Dorothy Lilian
C6	BOWN	Albert Henry
C6	BOWN	Henrietta
F1	BRADSHAW	Edith Maria
E43	BRADSHAW	Ernest
E43	BRADSHAW	Ethel
F1	BRADSHAW	John Edward
E46	BROOK	Benjamin Horace
E46	BROOK	Lily Violetta
A4	BROWETT	Clara Ellen
A4	BROWETT	Henry Arthur
C7	BRUNSKILL	Joseph
C7	BRUNSKILL	Lavinia
F6	BURLEY	Sarah
F6	BURLEY	William Cooper
D3	CLARK	Thomas Henry
D3	CLARK	Violet Jessie
E6	CLARKE	Edwin
F8	CLARKE	Joan Mary
E6	CLARKE	Margaret Gena
E6	CLARKE	Maurice G
E6	CLARKE	Sarah May
F3	COLEMAN	Ann
A12	COLEMAN	Elizabeth
E41	COX	Grace Mabel
A8	CRAVEN	Harriet
A13	DEACON	Hilda Cluer

Grave	Surname	Forename
A13	DEACON	Thomas Francis
C8	DICKENS	Samuel Panter
D16	DIXON	Alice Mary
D16	DIXON	Reginald George
D16	DIXON	Roger
B10	DODSON	Alice
C13	DODSON	Horace
B10	DODSON	James William
B10	DODSON	Margaret Nancy
E18	DUNMORE	Annie
E14	ELLINGWORTH	George
D5	EXAQUIS	Ignotus
A14	FRECKELTON	Ethel R
A14	FRECKELTON	Sydney
E28	FREESTONE	Harriett
E27	FREESTONE	Thomas Harrold
E28	FREESTONE	Thomas Harrold
C1	GARDNER	Christopher
C2	GARDNER	Christopher V
C1	GARDNER	Florence
C1	GARDNER	Elizabeth
C1	GARDNER	George
E26	GEARY	Emily
E26	GEARY	Fanny
E26	GEARY	George
E26	GEARY	Willie
A6	GODDARD	Alexander
A6	GODDARD	Annie
A6	GODDARD	Annie
D13	GODDARD	Emily
A6	GODDARD	Gertrude Phillips
		Gordon
A6	GODDARD	Henry Gordon
A6	GODDARD	Henry Langton
A6	GODDARD	Joseph
A6	GODDARD	Joseph
D13	GODDARD	Ralph
A6	GODDARD	Sylvia Harriet
		Gordon
A10	GRAY	Elizabeth
A10	GRAY	George
A11	GRAY	George
F9	GREEN	John M
E22	GREGORY	Florence
Inside	HALFORD	E Ursula
A2	HALFORD	Elizabeth Ursula, Dame

# The Church of St Luke, Newton Harcourt

Grave	Surname	Forename
A2	HALFORD	Henry St John, Sir
A3	HALFORD	John Frederick, Revd Sir
B15	HARRISON	Anne
B15	HARRISON	Richard
E19	HAYWARD	Sarah
C5	HOLMES	Mary Ann
B2	HOWARD	David
C11	HURST	Andrew William
C11	HURST	Sarah Ann
A6	ILLINGWORTH	Ellen H
E11	INGHAM	David George
E13	INGHAM	David George
E11	INGHAM	Gwendoline Mary
D18	JARMAN	Leonard Charles
D18	JARMAN	Mabel Doris
E16	JARMAN	Paul Charles
E2	JOHNSON	Carregwen Louvaine
E2	JOHNSON	John Beckett
E2	JOHNSON	William
E24	KNIGHT	Catherine
E24	KNIGHT	Edward William
F2	LACEY	Olive Brenda
F2	LACEY	Wilfred Herbert
E13	LEE	Albert Edward Anthony
E11	LEE	Tony
D2	LEMANIS	Elizabete
A9	LEVESLEY	Mabel
E25	LINGEN	Annie
E25	LINGEN	Edward Thomas
E25	LINGEN	Thomas
A7	LLOYD	Margaret Jessica
E23	MAJOR	Frank
E23	MAJOR	Marion
B9	MARTIN	Amy Grace
B9	MARTIN	Anna Sarah
B9	MARTIN	Charles Robert
B9	MARTIN	Derek
B9	MARTIN	Ethel Maud
B9	MARTIN	Hettie
F12	MARTIN	John Douglas
D15	MATTOCK	Ernest David
D15	MATTOCK	Minnie
B5	MOORE	Florence Edith
B5	MOORE	George Purdy
B3	NEWTON	Ethel M
B3	NEWTON	William J
E15	NOBBS	Gregory H E
E15	NOBBS	Nora
E17	NOBBS	Nora
D6	OAKEY	Frederick

Grave	Surname	Forename
D6	OAKEY	Lilian Alice
C13	OWEN	Mabel
C12	OWEN	T P
E44	PARKER	Mary Ann
E45	PARSONS	Henry
E32	POTTS	James H
B14	RICHARDS	Robert
B14	RICHARDS	Sarah Jane
E14	ROBERTS	Albert
E14	ROBERTS	Patricia Ann
E14	ROBERTS	Phyllis
C4	ROBINS	J A
D17	ROSS	Jo
D17	ROSS	Ronald
B1	SAUNDERS	Anne
B4	SCHWAUSCH	Barbara
E12	SCOTCHBROOK	Annie Maria
E12	SCOTCHBROOK	Emma Louise
B13	SHAW	Daisy
B13	SHAW	Ewert
E33	SHEPPARDS	Arthur
F7	SHEPPARDS	Bert
F7	SHEPPARDS	Connie
E30	SHEPPARDS	Florence Emily
D7	SIMKIN	Margaret
C9	SMART	Albert Ernest
C10	SMART	Hilda Margaret
C9	SMART	Margaret
C10	SMART	William Edgar
Brass vase in church	SMART	William Edgar
D2	SMITZ	Anna
F10	SNELL	Thomas Joseph
D1	STEINTHAL	Rebecca
B12	THOMPSON	Thomas
B8	THOMSON	Trevor Edward
F13	TURNBULL	Thomas
seat in area 'A'	TURNBULL	Thomas
E29	TURNER	Ellen Elizabeth
E29	TURNER	Joseph
E29	TURNER	Mary Elizabeth
D14	TWIGG	Hannah
E34	TYRRELL	Elizabeth Mary
E34	TYRRELL	John Norman
A6	WALMSLEY	Josephine Mary
A5	WARD	Charles Bryan
A5	WARD	Elizabeth Ellen
A5	WARD	May
E3	WATERTON	Joseph
E3	WATERTON	Rose Maria
A1	WHISTON	Henry

# The Church of St Luke, Newton Harcourt

Grave	Surname	Forename
A1	WHISTON	Mary Elizabeth
F11	WILLIAMS	(not given)
E42	WILLIAMSON	Ann
E42	WILLIAMSON	Joseph
B6	WITHERS	Sarah Ann
B6	WITHERS	Thomas
D12	WOOD	Alice Eliza
D12	WOOD	John
D7	WOOLLEY	Arthur Henry

Grave	Surname	Forename
F5	WOOLLEY	Betsey
D7	WOOLLEY	Gladys Irene
F4	WOOLLEY	Sarah Jane
F5	WOOLLEY	William
E13	WYATT	Gertrude A
E13	WYATT	John W